

TOTAL EXTENT (LEAST EXTENT AS PER PATTI) : 4315 SQ.M
ROAD AREA : 1523 SQ.M
NO.OF.PLOTS : 18 NOS

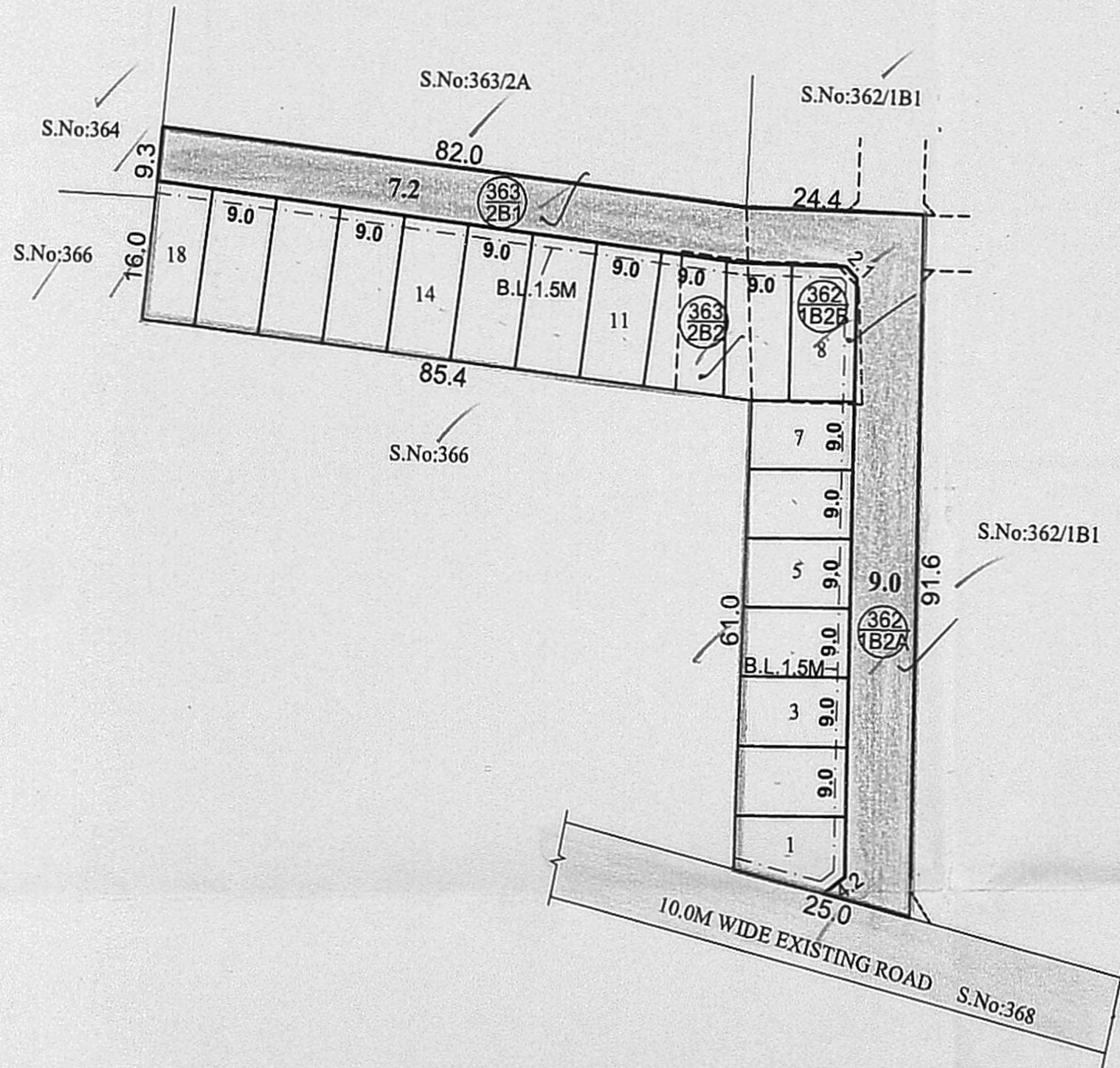

NOTE:

1. SPLAY - 1.5M X 1.5M , 3.0M X 3.0M
2. MEASUREMENTS ARE INDICATED EXCLUDING SPLAY DIMENSION
3. ROAD AREA WAS HANDED OVER TO THE LOCAL BODY
 VIDE GIFT DEED DOCUMENT NO. 18569/2017, DATED: 28/12/2017, @ SRO KUNDRATHUR

CONDITIONS :

DR RULE NO : 29 (11)

THE COST OF LAYING IMPROVEMENTS TO THE SYSTEMS INRESPECT OF ROAD, WATER SUPPLY, SEWERAGE, DRAINAGE OR ELECTRIC POWER SUPPLY THAT MAY BE REQUIRED AS ASSESSED BY THE COMPETENT AUTHORITY SHALL BE BORNE BY THE APPLICANT.

LEGEND :

- SITE BOUNDARY
- ROADS GIFTED TO LOCAL BODY
- EXISTING ROAD

PREPARED BY
[Signature]
 P.A.II
 11/1/18

[Signature]
 11/01/2018
 23/01/2018
 P.A.II (A.A)

[Signature]
 11/01/2018
 23/01/2018
 A.P(S.A)

[Signature]
 29/01/2018
 D.P (S.K)

[Signature]
 20/1/18
 C.P (M.S.B)

[Signature]
 20/1/18
 M.S.

POONAMALLEE PANCHAYAT UNION
LAYOUT OF HOUSE SITES IN S.NOS. 362/1B2A, 1B2B, 363/2B1 AND S.NO. 363/2B2 OF KANNAPALAYAM VILLAGE.

SCALE-1:800 (ALL MEASUREMENTS ARE IN METRE)

